

Boardwalk

Dean Lane SOUTHVILLE

APPROXIMATE FLOOR AREA
118.2 SQM / 1273 SQFT

BOOK A VIEWING
01179 898 222
hello@boardwalkpropertyco.com



GROUND FLOOR
517 sq.ft. (48.0 sq.m.) approx.

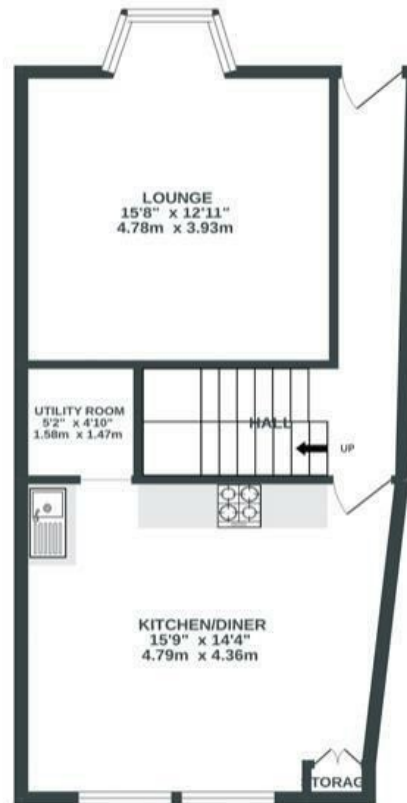

1ST FLOOR
493 sq.ft. (45.8 sq.m.) approx.



2ND FLOOR
263 sq.ft. (24.4 sq.m.) approx.



Illustrations are for reference purposes only, measurements are approximate, not to scale.

Boardwalk

Dean Lane

SOUTHVILLE, BRISTOL



£380,000



2 Bedrooms



BS3 1DB



3 Bathrooms

"We love being part of a small and welcoming community. The garden at Dame Emily park, the school, and the shops and restaurants around Wapping Wharf are all close by and always full of people we know, and we have almost everything we need within walking distance."

